

SITE ASSESSMENT



Job Title: **North-West & Neagh-Bann CFRAM**

JBA Job number: 2011s5232

Sheet number: 1 of 4

Site Name: KILMAINHAMWOOD

UM Approval: Ross Bryant

Name: Kilmainhamwood	County: Meath	HA: 6	Unique ID: 60021														
Source of Flooding (Fluvial / Tidal): Fluvial		Type: Risk Review															
Visit By: John Daly		Date of Visit: 15/09/11															
PFRA Data / Comments (taken from 110310_Final Database): <i>Likely errors in predictive mapping, and no other strong evidence to indicate that the area is prone to significant flood risk.</i> <i>Risk Review - Not an AFA</i>																	
PFRA Database Comments (taken from 110309_ALL_VAL - Post Round Two - MA.mdb): OPW comments <i>No comment in database</i> LA comments <i>No comment in database</i>																	
Watercourses / Sources of Flooding: The main source of flooding in Kilmainhamwood is a fluvial risk posed by the Kilmainham River which passes through the village.																	
Maps: See Flood Risk Review Site Map below.																	
Flood Outlines and Receptors: The receptors in Kilmainhamwood are 4 residential properties downstream for the bridge, the church and some properties adjacent to the church. There is a Nursing Home and Primary School in the village but are located a significant distance from the watercourse and PFRA outlines.																	
<table border="1"><thead><tr><th>Flood Risk Receptor</th><th>FRI Score</th></tr></thead><tbody><tr><td>Name</td><td>Kilmainhamwood</td></tr><tr><td>TOTAL_FLUV</td><td>160</td></tr><tr><td>Res_tot_prob_F_S</td><td>100</td></tr><tr><td>Com_tot_prob_F_C</td><td>20</td></tr><tr><td>Arch_Regional_Weighted_F_E</td><td>40</td></tr><tr><td>Total_FRI Score</td><td>160</td></tr></tbody></table>				Flood Risk Receptor	FRI Score	Name	Kilmainhamwood	TOTAL_FLUV	160	Res_tot_prob_F_S	100	Com_tot_prob_F_C	20	Arch_Regional_Weighted_F_E	40	Total_FRI Score	160
Flood Risk Receptor	FRI Score																
Name	Kilmainhamwood																
TOTAL_FLUV	160																
Res_tot_prob_F_S	100																
Com_tot_prob_F_C	20																
Arch_Regional_Weighted_F_E	40																
Total_FRI Score	160																
Comment on Flood Outlines: The PRFA Flood Risk Index scores Kilmainhamwood 160 with residential and commercial properties accounting for 120 (100 & 20) and Regional Architecture accounting for the remaining FRI score of 40. There is little difference between the 10% AEP outlines and the 1% AEP outlines. The OPW has highlighted an area of the flood extents (near the church) to be too conservative this was confirmed from observation during the site visit.																	
Defence Assets and Structures: The three-arch masonry bridge to the north of Kilmainhamwood is the key structure in the area. Blockage of this structure would increase the flood risk to adjacent properties.																	
Environmental Impacts and Opportunities: There are no designated sites of nature conservation interest within, or located in close proximity, to this																	

Job Title: **North-West & Neagh-Bann CFRAM**

JBA Job number: 2011s5232

Sheet number: 2 of 4

Site Name: KILMAINHAMWOOD

UM Approval: Ross Bryant

area.

There are approximately three monuments and 14 buildings included on the NIAH located within, or in close proximity to, this area.

Floodmaps.ie Data:

Kilmainhamwood between pitch and village recurring 15/Apr/2005 Minutes of meeting identifying areas subject to flooding - Meath - Kells Area Engineer (Report Includes: Frequency, Cause)

- 43. Kilmainhamwood CR 104 – River overflows its banks after heavy rain every year. The water flows along the road. Flood Id = 785
- 47. Kilmainhamwood between football pitch and village– Low lying land floods every year after heavy rain. Inadequate drainage Flood id = 793

Other Relevant Information:

Strategic Flood Risk Assessment for County Meath - JBA Consulting - June 2011: *Kilmainhamwood was identified to be at flood risk and it is intended that settlement specific FRA will be undertaken in conjunction with the LAP reviews. The outcomes of the CFRAM studies, when available, will be taken into consideration in future FRAs carried out in the County.*

Discussions with Key Stakeholders:

Meath County Council is currently preparing a response to our request for information on flooding.

Key Contacts (local authority, local or community groups):

Name	Position	Email	Tel	Mobile
Adrian Hobbs	Senior Executive Engineer	ahobbs@meathcoco.ie	042 932 4339	
Shane Hayes	OPW Area Engineer	shane.hayes@opw.ie	046 9431352	087 2627583

Consultations with OPW Area engineer - not aware of flooding here but OPW maintain channels. A local resident confirmed that channels are dredged by OPW.

Site Visit Findings:

The site visit has highlighted areas of the flood outlines where the extents should be reduced; resulting in the subtraction of the Church (Architecture Regional - 40) and 6 residential properties from the FRI. This has been carried out in the revised PFRA boundary shown below.

- The photograph of the right bank of the Kilmainhamwood River (on which the Church is located) is considerably higher than the left bank (where there are no receptors) this lowers risk to receptors on right bank.
- There is low risk to the school (40m) and the Nursing Home (~100m) from fluvial flooding as the distance and height from watercourse is large for the two receptors.
- 4 residential properties are confirmed to be at risk near the bridge. Local knowledge suggests that they have recently flooded and remedial work (dredging) has been carried out on the watercourse.

SITE ASSESSMENT

Job Title:	North-West & Neagh-Bann CFRAM	JBA Job number:	2011s5232
Site Name:	KILMAINHAMWOOD	Sheet number:	3 of 4
		UM Approval:	Ross Bryant



Property downstream of Bridge has history of flooding



Right Bank of Kilmainhamwood River upstream of Bridge

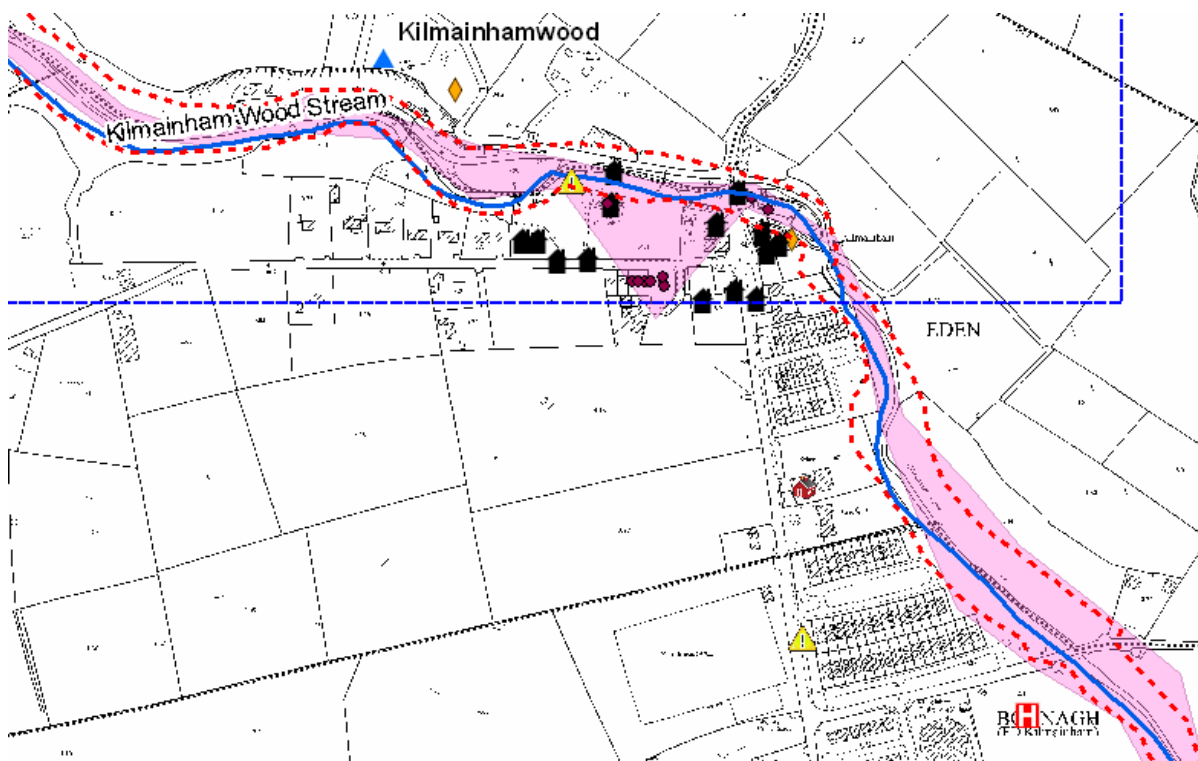

OSi Licence No. EN 0021011

Recommended Extreme Flood Outline

Summary:

The evidence base gathered during the site visit and the collated historic evidence have confirmed that 6 residential properties as well as the Church can be removed from the flood outlines. This would result in a reduction of 100 points, the remaining risk includes for 4 residential properties near the bridge and a single remote property to the west, the final revised score is therefore 50 and the site is not recommended for inclusion as an AFA.

Final FRR Status	Non-AFA
-------------------------	----------------

SITE ASSESSMENT



Job Title: **North-West & Neagh-Bann CFRAM**

JBA Job number: 2011s5232

Sheet number: 4 of 4

Site Name: KILMAINHAMWOOD

UM Approval: Ross Bryant

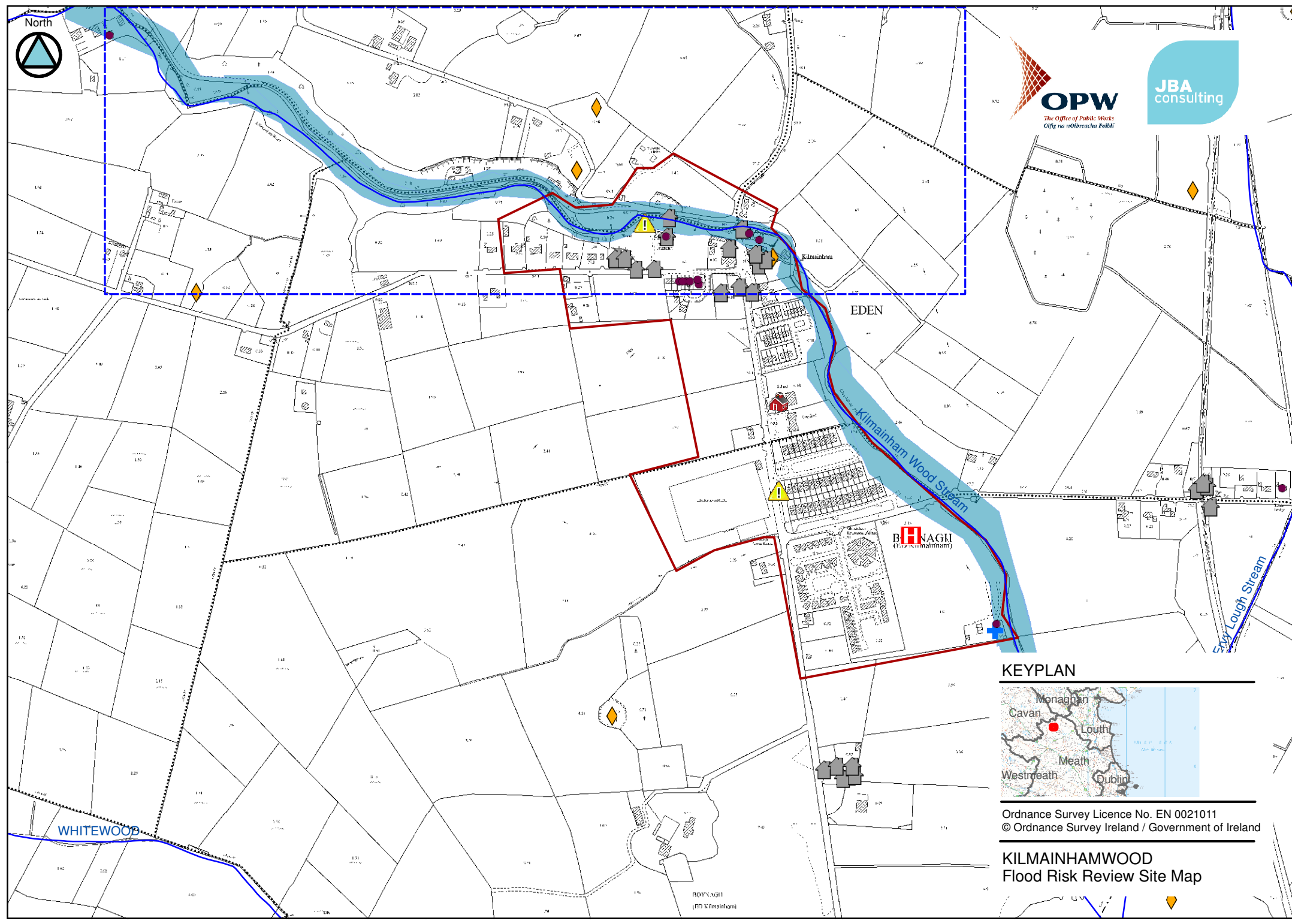

KEYPLAN

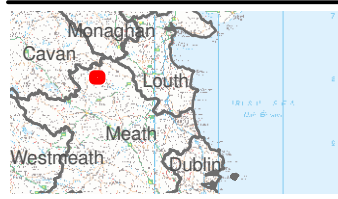

Ordnance Survey Licence No. EN 0021011
© Ordnance Survey Ireland / Government of Ireland

**KILMAINHAMWOOD
Flood Risk Review Site Map**

